

### **Attachment 3 –**

#### **SEWPBPD Biennial WPDES Report – March 31, 2021 to March 31, 2023**

#### **Illicit Discharge Detection & Elimination (IDDE) Reports and Documents**

*Where noted, refer to each relevant WPDES Permit at time of each inspection.*

- 6/3/2021 IDDE Inspection Forms.
- Komastu Spill – December 2021 email correspondence and public update statement by Komatsu for the Record.
  - 8/18/2022 IDDE Inspection Forms.
- Bus Release Incident (date 8/27/2021) – September 2021 email correspondence for the Record.
- 11/23/2022 IDDE Inspection Form – off-site discharge event including email correspondence November – December 2022 for the Record.

# Illicit Discharge Inspection

WPDES Permit No. WI-S049921-3

**Date:** June 3, 2021

**Time:** 8:15 p.m.

**Outfall Description:** 48" Major Discharge Outfall  
(note amended as of 4/5/2022 MO-1)

**Inspector(s):** Gregg DuBois

**Weather:** 80 °F, Partly Sunny

**Event Occurring at Miller Park:** Brewers vs. Arizona Diamondbacks at 6:40 p.m.

**Date of last rainfall:** May 29, 2021

**Amount of last rainfall:** 0.20"

## Visual Observations

**Flow observed:** No flow observed out of outfall.

**Color:** N/A

**Odor:** N/A

**Turbidity:** N/A

**Oil sheen:** N/A

**Surface scum/algae:** N/A

**Other:**

**Track Source:** N/A



# Illicit Discharge Inspection

WPDES Permit No. WI-S049921-3

**Date:** June 3, 2021

**Time:** 8:00 p.m.

**Outfall Description:** 36" Major Discharge  
Outfall(*note amended as of 4/5/2022 MO-2*)

**Inspector(s):** Gregg DuBois

**Weather:** 83 °F, Partly Sunny

**Event Occurring at Miller Park:** Brewers vs. Arizona Diamondbacks at 6:40 p.m.

**Date of last rainfall:** May 29, 2021

**Amount of last rainfall:** 0.20"

## Visual Observations

**Flow observed:** No flow observed.

**Color:** N/A.

**Odor:** N/A.

**Turbidity:** N/A.

**Oil sheen:** N/A.

**Surface scum/algae:** N/A.

**Other:**

**Track Source:** N/A.



# Illicit Discharge Inspection

WPDES Permit No. WI-S049921-3

**Date:** June 3, 2021

**Time:** 8:30 p.m.

**Outfall Description:** (3) 48" x 51" and (2) 76" Major Discharge Outfalls (*note amended as of 4/5/2022 MO-3N, MO-4M, MO-5S, MO-6N, MO-7S*)

**Inspector(s):** Gregg DuBois

**Weather:** 80°F, Partly cloudy

**Event Occurring at Miller Park:** Brewers vs. Arizona Diamondbacks at 6:40 p.m.

**Date of last rainfall:** May 29, 2021

**Amount of last rainfall:** 0.20"<sup>1</sup>

## Visual Observations

**Flow observed:** Flow coming from all pipes.

**Color:** Flow is clear.

**Odor:** No odor attributed to the flow was observed.

**Turbidity:** None noted.

**Oil sheen:** None noted.

**Surface scum/algae:** None noted.

**Other:**

Likely normal Wood Creek flow. Pipes are confluence of Wood Creek to the Menomonee River – Wood Creek normally carries flow (perennial).

**Track Source:** There was no flow within Park's contributing storm sewer system of the River West Parking Lots and South Access Road (catch basins are dry).

---

<sup>1</sup> <http://www.nws.noaa.gov/climate/index.php?wfo=mkx>



# Illicit Discharge Inspection

WPDES Permit No. WI-S049921-3

**Date:** June 3, 2021

**Time:** 8:50 p.m.

**Outfall Description:** 48" Major Discharge Outfall  
(note amended as of 4/5/2022 MO-8)

**Inspector(s):** Gregg DuBois

**Weather:** 80 °F, Partly cloudy

**Event Occurring at Miller Park:** Brewers vs. Arizona Diamondbacks at 6:40 p.m.

**Date of last rainfall:** May 29, 2021

**Amount of last rainfall:** 0.20"

## Visual Observations

**Flow observed:** No flow observed from outfall.

**Color:** N/A.

**Odor:** N/A.

**Turbidity:** N/A.

**Oil sheen:** N/A.

**Surface scum/algae:** N/A.

**Other:**

**Track Source:** N/A.



# OFF-SITE SPILL EVENT (KOMATSU)

**From:** [Kristi Kreklow](#)  
**To:** [Pat Goss](#); [Kathryn M. McNelly Bell](#); [Jeremy L. Schwartz, PE](#); [Greg Swindle](#)  
**Subject:** FW: 20211204SE41-1 - PETROLEUM - Significant Spill Notification  
**Date:** Tuesday, December 7, 2021 9:11:25 AM

---

Kristi Kreklow | Associate Director  
Southeast Wisconsin Professional Baseball Park District  
American Family Field  
1 Brewers Way , Milwaukee, WI 53214  
E-mail: [kkreklow@wibaseballdistrict.com](mailto:kkreklow@wibaseballdistrict.com)  
P: (414) 902-4045 C: (414) 628-5933

---

**From:** Neumann, Riley D - DNR <[Riley.Neumann@wisconsin.gov](mailto:Riley.Neumann@wisconsin.gov)>  
**Date:** Monday, December 6, 2021 at 7:00 PM  
**To:** Kristi Kreklow <[kkreklow@wibaseballdistrict.com](mailto:kkreklow@wibaseballdistrict.com)>  
**Subject:** RE: 20211204SE41-1 - PETROLEUM - Significant Spill Notification

That does make sense - thanks for clarification. We still need to figure out how so much sheen showed up. It was not from this one event.

Have a nice evening,  
Riley

Riley D. Neumann  
Cell: (414) 750-7030  
[Riley.Neumann@wisconsin.gov](mailto:Riley.Neumann@wisconsin.gov)

---

**From:** Kristi Kreklow <[kkreklow@wibaseballdistrict.com](mailto:kkreklow@wibaseballdistrict.com)>  
**Sent:** Monday, December 6, 2021 6:46 PM  
**To:** Neumann, Riley D - DNR <[Riley.Neumann@wisconsin.gov](mailto:Riley.Neumann@wisconsin.gov)>  
**Subject:** Re: 20211204SE41-1 - PETROLEUM - Significant Spill Notification

**CAUTION: This email originated from outside the organization.  
Do not click links or open attachments unless you recognize the sender and know the content is safe.**

Thanks Riley. I believe it may make sense that the Kamatsu storm sewers flow west into Wood Creek. Wood Creek discharges at the main outfall location where this was identified.

Get [Outlook for iOS](#)

---

**From:** Neumann, Riley D - DNR <[Riley.Neumann@wisconsin.gov](mailto:Riley.Neumann@wisconsin.gov)>

**Sent:** Monday, December 6, 2021 6:10:30 PM

**To:** Kristi Kreklow <[kkreklow@wibaseballdistrict.com](mailto:kkreklow@wibaseballdistrict.com)>

**Cc:** Pat Goss <[pgoss@wibaseballdistrict.com](mailto:pgoss@wibaseballdistrict.com)>; Bekele, Solomon <[sbekel@milwaukee.gov](mailto:sbekel@milwaukee.gov)>;

Sprangers, Kurt <[kspran@milwaukee.gov](mailto:kspran@milwaukee.gov)>; [kim.egan@westmilwaukee.org](mailto:kim.egan@westmilwaukee.org)

<[kim.egan@westmilwaukee.org](mailto:kim.egan@westmilwaukee.org)>; [james.stenzel@westmilwaukee.org](mailto:james.stenzel@westmilwaukee.org)

<[james.stenzel@westmilwaukee.org](mailto:james.stenzel@westmilwaukee.org)>

**Subject:** RE: 20211204SE41-1 - PETROLEUM - Significant Spill Notification

Good Evening,

I have not yet received the West Milwaukee maps – so I cannot comment on that yet. Warden Haferkorn and I stopped at Komatsu today and spoke with the EHS staff. They had a spill of under 1 gallon on Friday morning, some of which entered a nearby storm sewer, but this release was observed to be much more significant than what they calculated to have lost. They are hiring a contractor tomorrow to investigate, as they want to identify a problem if one exists. The sheen was much less significant today. We will continue to make observations.

The maps that Komatsu had on site were incomplete but went west under the roadway rather than north towards the River.

The Warden and I will speak to other businesses on this line once we receive the updated maps and we can let you all know when we hear from Komatsu.

Best,  
Riley

Riley D. Neumann

Cell: (414) 750-7030

[Riley.Neumann@wisconsin.gov](mailto:Riley.Neumann@wisconsin.gov)

---

**From:** Neumann, Riley D - DNR

**Sent:** Monday, December 6, 2021 1:44 PM

**To:** Kristi Kreklow <[kkreklow@wibaseballdistrict.com](mailto:kkreklow@wibaseballdistrict.com)>

**Cc:** Pat Goss <[pgoss@wibaseballdistrict.com](mailto:pgoss@wibaseballdistrict.com)>; Bekele, Solomon <[sbekel@milwaukee.gov](mailto:sbekel@milwaukee.gov)>;

Sprangers, Kurt <[kspran@milwaukee.gov](mailto:kspran@milwaukee.gov)>

**Subject:** RE: 20211204SE41-1 - PETROLEUM - Significant Spill Notification

I will provide an update when I know more.

Riley

Riley D. Neumann

Cell: (414) 750-7030

[Riley.Neumann@wisconsin.gov](mailto:Riley.Neumann@wisconsin.gov)

---

**From:** Kristi Kreklow <[kkreklow@wibaseballdistrict.com](mailto:kkreklow@wibaseballdistrict.com)>  
**Sent:** Monday, December 6, 2021 1:28 PM  
**To:** Neumann, Riley D - DNR <[Riley.Neumann@wisconsin.gov](mailto:Riley.Neumann@wisconsin.gov)>  
**Cc:** Pat Goss <[pgoss@wibaseballdistrict.com](mailto:pgoss@wibaseballdistrict.com)>; Bekele, Solomon <[sbekel@milwaukee.gov](mailto:sbekel@milwaukee.gov)>; Sprangers, Kurt <[kspran@milwaukee.gov](mailto:kspran@milwaukee.gov)>  
**Subject:** Re: 20211204SE41-1 - PETROLEUM - Significant Spill Notification

**CAUTION: This email originated from outside the organization.  
Do not click links or open attachments unless you recognize the sender and know the content is safe.**

Hi Riley,

I'm assuming you are reviewing the West Milwaukee maps as well? When you have an opportunity, can you please provide the District with information on any upstream cleanup efforts that have been undertaken and what future efforts will continue to be required? Since this spill is being released through the District's discharge point, we would like to make sure that we are kept aware of these efforts.

Thank you,  
Kristi

Kristi Kreklow | Associate Director  
Southeast Wisconsin Professional Baseball Park District  
American Family Field  
1 Brewers Way , Milwaukee, WI 53214  
E-mail: [kkreklow@wibaseballdistrict.com](mailto:kkreklow@wibaseballdistrict.com)  
P: (414) 902-4045 C: (414) 628-5933

---

**From:** Bekele, Solomon <[sbekel@milwaukee.gov](mailto:sbekel@milwaukee.gov)>  
**Date:** Monday, December 6, 2021 at 12:56 PM  
**To:** Neumann, Riley D - DNR <[Riley.Neumann@wisconsin.gov](mailto:Riley.Neumann@wisconsin.gov)>, Sprangers, Kurt <[kspran@milwaukee.gov](mailto:kspran@milwaukee.gov)>  
**Cc:** Mike Duckett <[mduckett@millerparkdistrict.com](mailto:mduckett@millerparkdistrict.com)>, Kristi Kreklow <[kkreklow@wibaseballdistrict.com](mailto:kkreklow@wibaseballdistrict.com)>  
**Subject:** RE: 20211204SE41-1 - PETROLEUM - Significant Spill Notification

Riley,

See attached. For the most part the area is owned by the Baseball Park District and there may not be public storm sewers.

Solomon Bekele



City of Milwaukee - Environmental Section  
(414) 286-0507

-----Original Message-----

From: Neumann, Riley D - DNR <[Riley.Neumann@wisconsin.gov](mailto:Riley.Neumann@wisconsin.gov)>  
Sent: Monday, December 6, 2021 9:23 AM  
To: Sprangers, Kurt <[kspran@milwaukee.gov](mailto:kspran@milwaukee.gov)>; Bekele, Solomon <[sbekel@milwaukee.gov](mailto:sbekel@milwaukee.gov)>  
Cc: [mduckett@millerparkdistrict.com](mailto:mduckett@millerparkdistrict.com); [kkreklow@millerparkdistrict.com](mailto:kkreklow@millerparkdistrict.com)  
Subject: RE: 20211204SE41-1 - PETROLEUM - Significant Spill Notification

Yes please see the email that was attached

Sent from my U.S.Cellular(c) Smartphone

----- Original message -----

From: "Sprangers, Kurt" <[kspran@milwaukee.gov](mailto:kspran@milwaukee.gov)>  
Date: 12/6/21 9:12 AM (GMT-06:00)  
To: "Neumann, Riley D - DNR" <[Riley.Neumann@wisconsin.gov](mailto:Riley.Neumann@wisconsin.gov)>, "Bekele, Solomon" <[sbekel@milwaukee.gov](mailto:sbekel@milwaukee.gov)>  
Cc: [mduckett@millerparkdistrict.com](mailto:mduckett@millerparkdistrict.com), [kkreklow@millerparkdistrict.com](mailto:kkreklow@millerparkdistrict.com)  
Subject: Re: 20211204SE41-1 - PETROLEUM - Significant Spill Notification

CAUTION: This email originated from outside the organization.  
Do not click links or open attachments unless you recognize the sender and know the content is safe.

Riley,  
Do you have a location for the outfalls in question?

Kurt

---

From: Neumann, Riley D - DNR <[Riley.Neumann@wisconsin.gov](mailto:Riley.Neumann@wisconsin.gov)>  
Sent: Monday, December 6, 2021 8:56 AM  
To: Bekele, Solomon <[sbekel@milwaukee.gov](mailto:sbekel@milwaukee.gov)>; Sprangers, Kurt <[kspran@milwaukee.gov](mailto:kspran@milwaukee.gov)>  
Cc: [mduckett@millerparkdistrict.com](mailto:mduckett@millerparkdistrict.com) <[mduckett@millerparkdistrict.com](mailto:mduckett@millerparkdistrict.com)>;  
[kkreklow@millerparkdistrict.com](mailto:kkreklow@millerparkdistrict.com) <[kkreklow@millerparkdistrict.com](mailto:kkreklow@millerparkdistrict.com)>  
Subject: FW: 20211204SE41-1 - PETROLEUM - Significant Spill Notification

Good Morning Gentlemen,

Please see the attachments and email chain below. This was from over the weekend and I plan to follow up today and perform a site visit. Can the City provide storm sewer maps of this release area? 2nd outfall from the left is the source outfall (in attached email).

We are attempting to find sources along this line.

Riley D. Neumann  
Cell: (414) 750-7030

[Riley.Neumann@wisconsin.gov](mailto:Riley.Neumann@wisconsin.gov)<mailto:Riley.Neumann@wisconsin.gov>

From: Rice, Caroline M - DNR <[caroline.rice@wisconsin.gov](mailto:caroline.rice@wisconsin.gov)>  
Sent: Saturday, December 4, 2021 6:54 PM  
To: DNR DL SER SIGNIFICANT SPILL <[DNRDLSERSIGNIFICANTSPILL@wisconsin.gov](mailto:DNRDLSERSIGNIFICANTSPILL@wisconsin.gov)>; Manteufel, Richard A - DNR <[RichardA.Manteufel@wisconsin.gov](mailto:RichardA.Manteufel@wisconsin.gov)>; [simon.verneta@epa.gov](mailto:simon.verneta@epa.gov); Zintak, Leonard <[zintak.leonard@epa.gov](mailto:zintak.leonard@epa.gov)>; Haferkorn, Samuel J - DNR <[Samuel.Haferkorn@wisconsin.gov](mailto:Samuel.Haferkorn@wisconsin.gov)>  
Subject: 20211204SE41-1 - PETROLEUM - Significant Spill Notification

Good evening,

I am sending out this significant spill notification for situational awareness. At 8:51 The Department was notified of a petroleum sheen on the Menomonee River in Milwaukee WI (see attached SERTS report). Below I have a summary of the actions taken and the current status.

- \* DNR Warden Sam Haferkorn responded. He made initial observations of the impacted area and assessed upstream to determine a potential source. A storm drain outlet was identified as a potential source.
- \* I notified the NRC of the spill report. EPA called back and offered assistance as needed.
- \* I contacted the City of Milwaukee Water Works. The Milwaukee Waterworks arrived on scene to

assess potential impacts to the storm sewer. It was then determined that the subject system was under the Milwaukee Metropolitan Sewage Department's (MMSD) control. MMSD was contacted. It did not seem likely that the subject outlet was the source.

- \* The U.S. Coast Guard called back and was on site assessing the impacts.
- \* Warden Haferkorn and the U.S. Coast Guard continued to observe impacts upstream of the previous outfall (further disqualifying the previous outfall as our source). EPA, DNR, and the coast guard discussed a response. The U.S. Coast Guard advised placing booms.
- \* Warden Haferkorn assessed further upstream and observed an outfall with petroleum impacted water flowing out from it.
- \* EPA alerted DNR to an NRC report EPA had received yesterday (12/3) regarding a petroleum spill to a storm sewer upstream of the observed impacts.
- \* EPA contacted the facility (Komatsu Mining Corp. Group) and discussed the situation.
- \* The facility was located near the observed impacted outfall.
- \* The facility hired a contractor to respond. The facility and their contractor coordinated with DNR and placed an absorbent boom at the subject outfall.
- \* We (DNR and the hired contractor) will continue to monitor the area.

At this point the source area is contained. I will send another email only if the situation changes.

Attached are pictures of the observed sheen

Please reach out with any questions or to discuss.

Thank you,

Caroline

We are committed to service excellence.

Visit our survey at <http://dnr.wi.gov/customersurvey> to evaluate how I did.

Caroline Rice

she/her/hers

Hydrogeologist- Bureau of Remediation & Redevelopment Wisconsin Department of Natural Resources

3911 Fish Hatchery Road, Fitchburg WI 53711

Phone number: (608) 219-2182

[caroline.rice@wisconsin.gov](mailto:caroline.rice@wisconsin.gov)<mailto:caroline.rice@wisconsin.gov>

[cid:image001.png@01D7E93D.81F2D150]<<http://dnr.wi.gov/>>dnr.wi.gov<<http://dnr.wi.gov/>>

[cid:image002.png@01D7E93D.81F2D150]<<http://facebook.com/WIDNR>>

[cid:image003.png@01D7E93D.81F2D150]<<https://twitter.com/WDNR>>

[cid:image004.png@01D7E93D.81F2D150] <<http://www.youtube.com/user/WIDNRTV>>

[cid:image005.png@01D7EA7F.2CC9FC60]

<<https://public.govdelivery.com/accounts/WIDNR/subscriber/new>>

The City of Milwaukee is subject to Wisconsin Statutes related to public records. Unless otherwise exempted from the public records law, senders and receivers of City of Milwaukee e-mail should presume that e-mail is subject to release upon request, and is subject to state records retention requirements. See City of Milwaukee full e-mail disclaimer at [www.milwaukee.gov/email\\_disclaimer](http://www.milwaukee.gov/email_disclaimer)

## **Looking for a Komatsu website outside of North America?**

Go to the Komatsu corporate website or a Komatsu website in your local region

# **Milwaukee oil spill updates**

## Public update – March 23, 2022

After nearly four months of ongoing work as part of a coordinated and comprehensive cleanup response effort to address the accidental Dec. 3 oil spill at our facility on W. National Avenue, our work to restore the waterways to pre-spill conditions is now complete to the extent practical. This determination is a result of regular assessment of our work and has been verified by an outside third-party expert.

During the cleanup, Komatsu crews recovered more than 13,800 gallons of water and oil sheen, using and disposing of 250 oil-soaked absorbent booms to also recover oil sheens. We also collected 122 bags of trash, debris and other materials from Milwaukee's waterways.

Out of an abundance of caution, we continue to monitor the waterways daily as the water goes through its ongoing freeze and thaw period as the seasons change, and have found no Komatsu-related impacts. We have invested in not only the cleanup itself, but in working to implement corrective measures, policies and procedures to ensure this does not happen again here or at any of our other facilities and to enhance our communications efforts with the community.

We take seriously our duty to be a responsible business and productive member of our community. We sincerely regret that this incident occurred and are fully committed to doing better moving forward.

## Public update - Feb. 10, 2022

As part of our ongoing response to the accidental oil spill on Dec. 3 at our facility on W. National Ave., we are continuing to proactively maintain a series of booms on the Menomonee River designed to absorb any oil sheen that may appear in the future. We also continue to conduct daily inspections to confirm that our response activities are complete.

We encourage members of the public to let us know about areas of potential sheen for our crews to assess. To report any areas of concern, we encourage direct messages to our @KomatsuMining Facebook page.

We at Komatsu believe our corporate value is the total sum of trust given to us by society and our stakeholders. We sincerely regret that this incident occurred and are fully committed to making this right and doing better moving forward.

## Public update - Jan. 19, 2022

We estimate that we have now removed approximately 95% of the visible sheen on Milwaukee's waterways that resulted from the accidental oil spill on Dec. 3 at our facility on W. National Ave. As of today, it has been 11 days since we last saw any sheens or received reports of sheen in the waterways related to the incident.

We are also pleased to report that the snowy owl and Canada goose that may have been affected by the spill are on the mend, thanks to the great work of the Wisconsin Humane Society. The Canada goose was released back into the wild last week, and we are hopeful that the snowy owl will be ready for release soon. We will continue to support the WHS for its costs related to the rehabilitation of these animals.

On Monday of this week, we submitted our 45-day response action report to the Wisconsin Department of Natural Resources. Included in that detailed report is our

assessment that the visible sheen resulting from the spill has been removed to the extent practicable. We will continue to monitor the situation by conducting regular inspections of the river to confirm that our response activities are complete. We also remain committed to working with the WDNR in relation to the incident, as the Department has been actively engaged throughout the cleanup process.

We continue to invite members of the public to let us know about areas of potential sheen for our crews to respond. To report any areas of concern, we encourage direct messages to our @KomatsuMining Facebook page.

We at Komatsu believe our corporate value is the total sum of trust given to us by society and our stakeholders. We sincerely regret that this incident occurred and are fully committed to making this right and doing better moving forward.

## Public update - Jan. 7, 2022

Our crews have been able to remove an estimated 90-95% of oil sheen from Milwaukee's waterways and we remain vigilant in our daily patrol and recovery efforts of any remaining visible sheen resulting from the accidental oil spill that occurred December 3 at our Joy Global facility on W. National Ave. Our cleanup work continues.

When we initially created and implemented our cleanup action plan, we knew that winter weather, safety and waterway logistics would be challenges to our work.



However, due to a warmer than usual December, we had the opportunity to continue our work on the water for longer than we had initially anticipated and worked hard to leverage each additional day.

During this past month of remediation:

Our crews recovered more than 13,000 gallons of water and oil sheen  
146 absorbent booms were also used to recover oil sheens

While they were out there, our crews also recovered 93 bags of trash, debris and other materials from Milwaukee's waterways.

Now that colder temperatures have set in, our daily cleanup efforts are continuing, adapted to the weather, and we are keeping in mind the safety of the crews performing the work. Our crews continue to do daily visual inspections of the water to look for areas for remediation, address cleanup spots when possible, and document environmental impacts and weather conditions to determine the best action steps available on each given day.

As an adjustment to the colder temperatures, some absorbent booms have been removed to ensure they do not break down in the water. We are closely monitoring the locations where booms remain in place to determine how long they can remain in use and when those may also need to be removed because of weather conditions. We are no longer deploying boats at this time because of the weather but will be ready to mobilize them again if further action is necessary and the weather conditions allow.

We continue to stay in contact with and coordinate with the Wisconsin Department of Natural Resources, and we remain committed to working with the WDNR, as the

Department has been actively engaged throughout the cleanup process.

We remain thankful to the members of the public and community groups who have sent in updates and reports on areas of potential sheen for our crews to respond. To report any areas of concern, we encourage direct messages to our @KomatsuMining Facebook page.

We sincerely regret that this incident occurred and are committed to supporting the cleanup. Internal procedural changes have already been made and we continue to look at ways to improve through additional training, enhanced procedures, engineering and institutional controls.

## Public update - Dec. 22, 2021

We estimate we have been able to recover more than 80% of oil residue on Milwaukee's waterways and our crews continue to make daily progress, following the Dec. 3 oil spill from a container at our Joy Global facility on W. National Ave. In our team's status report Dec. 21, the cleanup effort's Emergency Response Team Director reported "a dramatic decrease since last Thursday" in identified areas of oil concentration and that our crews have recovered thousands of gallons of water and sheen thus far.

On a daily basis, groups of employees and volunteers are walking the waterways to continue looking for areas of residue. The Wisconsin Department of Natural

Resources and others in the community are assisting with identifying spots, which we then respond to leveraging several techniques at our disposal, including: spot skimming, absorbent bales, a vacuum truck, stationary booms and manned boats. We are working closely with the WI DNR on any additional methods to complete the remaining cleanup process.

We typically have 3-4 boats out on the waterways each day, with an additional land crew manning a vacuum truck to enable access to oil pockets and sheen at difficult locations along the shorelines. Work is ongoing and all efforts to address this spill are being considered as we work toward resolution. Based on the spots remaining, we will continue to evaluate daily staffing needs and adjust our crews accordingly.

We are working to capture the remainder and will continue to do so vigilantly as areas of potential oil are identified by our crews or members of the public. To make it easy for members of the public to report any spotting of potential oil, we encourage direct messages to our @KomatsuMining Facebook page. We appreciate the support of the community and employee volunteers who have been providing updates and we take each of those reports seriously as we work to implement cleanup procedures.

We sincerely regret that this incident occurred and are committed to supporting the immediate and longer-term needs of correcting the matter. We are working directly with Wisconsin Humane Society to sponsor the care of the two animals they are supporting that may have been affected by this incident.

## Public update - Dec. 13, 2021

Since Dec. 3, when staff at our Joy Global facility on W. National Ave. became aware of a spill of used oil from a container at that site and immediately alerted proper authorities including the U.S. Coast Guard National Response Center, we've been working with Wisconsin Department of Natural Resources and the emergency response cleanup contractors we hired to aggressively address the situation as quickly as possible. At this time, we estimate we have been able to recover about 80% of oil residue on Milwaukee's waterways, and we are working rapidly to address the remainder. The used oil that was spilled is reported to be a combination of spent cutting, hydraulic and lubrication oils generated from our manufacturing process.

We appreciate the support of the community and employee volunteers who have been providing updates on any spotting of potential oil spread and we take each of those reports seriously as we work to implement cleanup procedures. Our approach to the cleanup is in coordination with the WI DNR, who we have been working closely with during each phase of the cleanup. There were two boat crews out on the waterways on Friday and three boat crews on Saturday, with an additional land crew working on cleanup response efforts on both days. Sunday's activities included two boat crews on the rivers and one land crew with a vacuum truck to enable access to oil pockets and sheen at difficult locations along the shorelines. Work is ongoing today and we had four boats out as part of the continued cleanup. All efforts to address this spill are being considered and aggressively implemented.

We sincerely regret that this incident occurred and are committed to supporting the immediate and longer-term needs of correcting the matter. We want to thank the

community groups and stakeholders who have helped inform us throughout this process as we work to remedy this situation as quickly as possible.

## Statement

On Friday, Dec. 3, our staff at our Joy Global facility on W. National Ave. became aware of what we thought at that time was a relatively small spill of waste oil from a container. Upon learning of this spill, we immediately began cleanup procedures and reported the matter to the state Department of Natural Resources and the regional staff of the U.S. Environmental Protection Agency.

As cleanup work continued this week, it became clear that the spill was more extensive than initially thought and we began to implement a more aggressive cleanup and remediation effort. We are in the midst of investigating how this very regrettable accident occurred and we are focused on continuing to implement aggressive cleanup efforts to remediate the situation as quickly as possible.

Our expanded cleanup efforts include immediate plans to place absorbent containment devices or “booms” to contain the oil in the areas where any concern of waste has been noticed, including spots in the Menomonee, Kinnickinnic and Milwaukee rivers, as well as the tributary below the Hoan Bridge. We have employed a professional, national spill response team to help guide this effort. Our cleanup and remediation response plans include the placement of the containment booms noted above, as well as the use of a boat and vacuum truck to remove any oil that

has been spilled. We remain in consistent contact with the Wisconsin DNR and the EPA, and we are in the process of reaching out to other stakeholders in the area to brief them on the situation.

We are monitoring any and all reported impacts to area wildlife and waterways and plan to support necessary care required through monetary donations to the care agencies involved. We sincerely appreciate the assistance and concern of the public and the wildlife experts and volunteers who support our region on a daily basis.

We sincerely regret this unfortunate accident occurred and want to apologize to the Milwaukee and Wisconsin community for any harm that has been caused. We are devoting all necessary resources toward an aggressive and complete remediation effort to resolve the situation as quickly as possible and we are committed to determining the root cause to ensure such an incident does not happen again. We take seriously our duty to operate responsibly and within the rules and regulations that have been established for our facilities, and we strive to serve as a responsible corporate citizen in good times and through challenges, as we have for over 100 years. We will update the community and key stakeholders when we have further information.

Komatsu is a leading manufacturer of construction, mining, forestry, and industrial heavy equipment.

**Discover**  
Products  
Parts and attachments

**Tools**  
Request a quote  
Locator tool  
My Komatsu

**Company**  
About  
Blog  
Careers

**Connect**  
Contact us  
Social media  
Customer / dealer portals

Services and  
support  
Industries  
Site optimization

Competitive  
comparison

Commitment to  
society  
Events  
Merchandise  
Newsroom  
Success stories  
Investor relations

Suppliers

United States - English

Units: US Customary

[California supply chain transparency act](#)   [Privacy statement](#)   [Privacy notice for California residents](#)

[Cookie policy](#)   [Terms of use](#)   [Transparency in Coverage](#)   [Sitemap](#)

Copyright © 2023 Komatsu. All rights reserved.

# Illicit Discharge Detection and Elimination (IDDE) Inspection Form

WPDES Permit No. WI-S049921-04

Inspection form effective date: August 1, 2022

<b>Date:</b> August 18, 2022	<b>Inspector(s) Name(s):</b> Kathryn McNelly Bell & Megan Ruemler
<b>Time:</b> 2:50 PM	<b>Inspector(s) Title(s):</b> Natural Resources Staff
<b>Major Outfall Inspected (highlight one):</b> <b>MO-1</b> MO-2 MO-3N MO-4M	<b>Inspectors Phone Number(s):</b> 414-795-4305
MO-5S MO-6N MO-7S MO-8	<b>Weather:</b> 80 °F, Partly Sunny
<b>Event occurring at ballpark:</b> 1:10 PM game VS. LA Dodgers (Brewers won 5-3)	<b>Amount of last rainfall (list source):</b> 0.02" (National Weather Service; weather.gov)
<b>Date of last rainfall:</b> 8/13/22	

## Visual Observations

**Flow observed:** Yes/**No** – If Yes continue filling out remainder of this section.

**Color:** N/A

**Odor:** Yes/No/**N/A**

**Turbidity:** Yes/No/**N/A**

**Oil sheen:** Yes/No/**N/A**

**Surface scum/algae:** Yes/No/**N/A**

**Flow rate (monitoring equipment can provide flow rates if flow at outfall is greater than 1.25" in depth – if less than 1.25" in depth please state this):**

### Other Relevant Observations:

Water level of River is resulting in backwater effect in the outfall (water is clear). Observed contributing District owned storm sewer inlets- in Lot 10/Mathews Lot – inlets were dry, containing no flow.

If suspect, illicit discharge is observed originating from SEWPBPD's owned and operated MS4, field analysis shall be conducted. Refer to the IDDE Program Manual and the WPDES Permit, Section II, C.2.e to track source. If illicit discharge originates from the ballpark sample(s) will be collected for lab analysis.

### Sampling summary if illicit discharge originates from SEWPBPD's owned and operated MS4

Time of Sampling:            Bottle Numbering:

Lab Drop Off Date/Time:

Maintain Chain of Custody on File with this Inspection Report.





# Illicit Discharge Detection and Elimination (IDDE) Inspection Form

WPDES Permit No. WI-S049921-04

Inspection form effective date: August 1, 2022

<b>Date:</b> August 18, 2022	<b>Inspector(s) Name(s):</b> Kathryn McNelly Bell & Megan Ruemler
<b>Time:</b> 2:30 PM	<b>Inspector(s) Title(s):</b> Natural Resources Staff
<b>Major Outfall Inspected (circle one):</b> MO-1 <b>MO-2</b> MO-3N MO-4M	<b>Inspectors Phone Number(s):</b> 414-795-4305
MO-5S MO-6N MO-7S MO-8	<b>Weather:</b> 80 °F, Partly Sunny
<b>Event occurring at ballpark:</b> 1:10 PM game VS. LA Dodgers (Brewers won 5-3)	<b>Amount of last rainfall (list source):</b> 0.02" (National Weather Service; weather.gov)
<b>Date of last rainfall:</b> 8/13/22	

## Visual Observations

**Flow observed:** Yes/No – If Yes continue filling out remainder of this section.

**Color:** Clear/no color

**Odor:** Yes/No/N/A

**Turbidity:** Yes/No/N/A

**Oil sheen:** Yes/No/N/A

**Surface scum/algae:** Yes/No/N/A

**Flow rate (monitoring equipment can provide flow rates if flow at outfall is greater than 1.25" in depth – if less than 1.25" in depth please state this):** Less than 1/8" in depth.

### Other Relevant Observations:

Normal groundwater observed. Observed no flow from the contributing District owned storm sewer inlets in the River West Lots. While we were in the River West Lot, we also inspected around all rows of RV/buses, twice during the game (between 2pm – 3pm), and found no illicit discharges from these vehicles.

If suspect, illicit discharge is observed originating from SEWPBPD's owned and operated MS4, field analysis shall be conducted. Refer to the IDDE Program Manual and the WPDES Permit, Section II, C.2.e to track source. If illicit discharge originates from the ballpark sample(s) will be collected for lab analysis.

### Sampling summary if illicit discharge originates from SEWPBPD's owned and operated MS4

Time of Sampling:

Bottle Numbering:

Lab Drop Off Date/Time:

Maintain Chain of Custody on File with this Inspection Report.



# Illicit Discharge Detection and Elimination (IDDE) Inspection Form

WPDES Permit No. WI-S049921-04

Inspection form effective date: August 1, 2022

<b>Date:</b> August 18, 2022	<b>Inspector(s) Name(s):</b> Kathryn McNelly Bell & Megan Ruemler
<b>Time:</b> 1:50 PM	<b>Inspector(s) Title(s):</b> Natural Resources Staff
<b>Major Outfall Inspected (circle one):</b> MO-1 MO-2 <b>MO-3N</b> MO-4M	<b>Inspectors Phone Number(s):</b> 414-795-4305
MO-5S MO-6N MO-7S MO-8	<b>Weather:</b> 80 °F, Partly Sunny
<b>Event occurring at ballpark:</b> 1:10 PM game VS. LA Dodgers (Brewers won 5-3)	<b>Amount of last rainfall (list source):</b> 0.02" (National Weather Service; weather.gov)
<b>Date of last rainfall:</b> 8/13/22	

## Visual Observations

**Flow observed:** Yes/No – If Yes continue filling out remainder of this section.

**Color:** Clear

**Odor:** Yes/No/N/A

**Turbidity:** Yes/No/N/A

**Oil sheen:** Yes/No/N/A

**Surface scum/algae:** Yes/No/N/A

**Flow rate (monitoring equipment can provide flow rates if flow at outfall is greater than 1.25" in depth – if less than 1.25" in depth please state this):** Typical Wood Creek flow- water level is below OHWM, less than 1" in depth.

### Other Relevant Observations:

Observed contributing District owned storm sewer inlets in the River West Lot and South Access Road - no flow observed. Inlets are dry.

If suspect, illicit discharge is observed originating from SEWPBPD's owned and operated MS4, field analysis shall be conducted. Refer to the IDDE Program Manual and the WPDES Permit, Section II, C.2.e to track source. If illicit discharge originates from the ballpark sample(s) will be collected for lab analysis.

### Sampling summary if illicit discharge originates from SEWPBPD's owned and operated MS4

Time of Sampling:

Bottle Numbering:

Lab Drop Off Date/Time:

Maintain Chain of Custody on File with this Inspection Report.



# Illicit Discharge Detection and Elimination (IDDE) Inspection Form

WPDES Permit No. WI-S049921-04

Inspection form effective date: August 1, 2022

<b>Date:</b> August 18, 2022	<b>Inspector(s) Name(s):</b> Kathryn McNelly Bell & Megan Ruemler
<b>Time:</b> 1:50 PM	<b>Inspector(s) Title(s):</b> Natural Resources Staff
<b>Major Outfall Inspected (circle one):</b> MO-1 MO-2 MO-3N <b>MO-4M</b>	<b>Inspectors Phone Number(s):</b> 414-795-4305
MO-5S MO-6N MO-7S MO-8	<b>Weather:</b> 80 °F, Partly Sunny
<b>Event occurring at ballpark:</b> 1:10 PM game VS. LA Dodgers (Brewers won 5-3)	<b>Amount of last rainfall (list source):</b> 0.02" (National Weather Service; weather.gov)
<b>Date of last rainfall:</b> 8/13/22	

## Visual Observations

**Flow observed:** Yes/No – If Yes continue filling out remainder of this section.

**Color:** Clear

**Odor:** Yes/No/N/A

**Turbidity:** Yes/No/N/A

**Oil sheen:** Yes/No/N/A

**Surface scum/algae:** Yes/No/N/A

**Flow rate (monitoring equipment can provide flow rates if flow at outfall is greater than 1.25" in depth – if less than 1.25" in depth please state this):** Typical Wood Creek flow- water level is below OHWM, less than 1" in depth.

### Other Relevant Observations:

Observed contributing District owned storm sewer inlets in the River West Lot and South Access Road - no flow observed. Inlets are dry.

If suspect, illicit discharge is observed originating from SEWPBPD's owned and operated MS4, field analysis shall be conducted. Refer to the IDDE Program Manual and the WPDES Permit, Section II, C.2.e to track source. If illicit discharge originates from the ballpark sample(s) will be collected for lab analysis.

### Sampling summary if illicit discharge originates from SEWPBPD's owned and operated MS4

Time of Sampling:

Bottle Numbering:

Lab Drop Off Date/Time:

Maintain Chain of Custody on File with this Inspection Report.



# Illicit Discharge Detection and Elimination (IDDE) Inspection Form

WPDES Permit No. WI-S049921-04

Inspection form effective date: August 1, 2022

<b>Date:</b> August 18, 2022	<b>Inspector(s) Name(s):</b> Kathryn McNelly Bell & Megan Ruemler
<b>Time:</b> 1:50 PM	<b>Inspector(s) Title(s):</b> Natural Resources Staff
<b>Major Outfall Inspected (circle one):</b> MO-1 MO-2 MO-3N MO-4M <b>MO-5S</b> MO-6N MO-7S MO-8	<b>Inspectors Phone Number(s):</b> 414-795-4305
<b>Event occurring at ballpark:</b> 1:10 PM game VS. LA Dodgers (Brewers won 5-3)	<b>Weather:</b> 80 °F, Partly Sunny
<b>Date of last rainfall:</b> 8/13/22	<b>Amount of last rainfall (list source):</b> 0.02" (National Weather Service; weather.gov)

## Visual Observations

**Flow observed:** Yes/No – If Yes continue filling out remainder of this section.

**Color:** Clear

**Odor:** Yes/No/N/A

**Turbidity:** Yes/No/N/A

**Oil sheen:** Yes/No/N/A

**Surface scum/algae:** Yes/No/N/A

**Flow rate (monitoring equipment can provide flow rates if flow at outfall is greater than 1.25" in depth – if less than 1.25" in depth please state this):** Typical Wood Creek flow- water level is below OHWM, less than 1" in depth.

### Other Relevant Observations:

Observed contributing District owned storm sewer inlets in the River West Lot and South Access Road - no flow observed. Inlets are dry.

If suspect, illicit discharge is observed originating from SEWPBPD's owned and operated MS4, field analysis shall be conducted. Refer to the IDDE Program Manual and the WPDES Permit, Section II, C.2.e to track source. If illicit discharge originates from the ballpark sample(s) will be collected for lab analysis.

### Sampling summary if illicit discharge originates from SEWPBPD's owned and operated MS4

Time of Sampling:

Bottle Numbering:

Lab Drop Off Date/Time:

Maintain Chain of Custody on File with this Inspection Report.



# Illicit Discharge Detection and Elimination (IDDE) Inspection Form

WPDES Permit No. WI-S049921-04

Inspection form effective date: August 1, 2022

<b>Date:</b> August 18, 2022	<b>Inspector(s) Name(s):</b> Kathryn McNelly Bell & Megan Ruemler
<b>Time:</b> 1:50 PM	<b>Inspector(s) Title(s):</b> Natural Resources Staff
<b>Major Outfall Inspected (circle one):</b> MO-1 MO-2 MO-3N MO-4M  MO-5S <b>MO-6N</b> MO-7S MO-8	<b>Inspectors Phone Number(s):</b> 414-795-4305
<b>Event occurring at ballpark:</b> 1:10 PM game VS. LA Dodgers (Brewers won 5-3)	<b>Weather:</b> 80 °F, Partly Sunny
<b>Date of last rainfall:</b> 8/13/22	<b>Amount of last rainfall (list source):</b> 0.02" (National Weather Service; weather.gov)

## Visual Observations

**Flow observed:** Yes/No – If Yes continue filling out remainder of this section.

**Color:** Clear

**Odor:** Yes/No/N/A

**Turbidity:** Yes/No/N/A

**Oil sheen:** Yes/No/N/A

**Surface scum/algae:** Yes/No/N/A

**Flow rate (monitoring equipment can provide flow rates if flow at outfall is greater than 1.25" in depth – if less than 1.25" in depth please state this):** Typical Wood Creek flow- water level is below OHWM, less than 1" in depth.

### Other Relevant Observations:

Observed contributing District owned storm sewer inlets in the River West Lot and South Access Road - no flow observed. Inlets are dry.

If suspect, illicit discharge is observed originating from SEWPBPD's owned and operated MS4, field analysis shall be conducted. Refer to the IDDE Program Manual and the WPDES Permit, Section II, C.2.e to track source. If illicit discharge originates from the ballpark sample(s) will be collected for lab analysis.

### Sampling summary if illicit discharge originates from SEWPBPD's owned and operated MS4

Time of Sampling:

Bottle Numbering:

Lab Drop Off Date/Time:

Maintain Chain of Custody on File with this Inspection Report.



# Illicit Discharge Detection and Elimination (IDDE) Inspection Form

WPDES Permit No. WI-S049921-04

Inspection form effective date: August 1, 2022

<b>Date:</b> August 18, 2022	<b>Inspector(s) Name(s):</b> Kathryn McNelly Bell & Megan Ruemler
<b>Time:</b> 1:50 PM	<b>Inspector(s) Title(s):</b> Natural Resources Staff
<b>Major Outfall Inspected (circle one):</b> MO-1 MO-2 MO-3N MO-4M MO-5S MO-6N <b>MO-7S</b> MO-8	<b>Inspectors Phone Number(s):</b> 414-795-4305
<b>Event occurring at ballpark:</b> 1:10 PM game VS. LA Dodgers (Brewers won 5-3)	<b>Weather:</b> 80 °F, Partly Sunny
<b>Date of last rainfall:</b> 8/13/22	<b>Amount of last rainfall (list source):</b> 0.02" (National Weather Service; weather.gov)

## Visual Observations

**Flow observed:** Yes/No – If Yes continue filling out remainder of this section.

**Color:** Clear

**Odor:** Yes/No/N/A

**Turbidity:** Yes/No/N/A

**Oil sheen:** Yes/No/N/A

**Surface scum/algae:** Yes/No/N/A

**Flow rate (monitoring equipment can provide flow rates if flow at outfall is greater than 1.25" in depth – if less than 1.25" in depth please state this):** Typical Wood Creek flow- water level is below OHWM, less than 1" in depth.

**Other Relevant Observations:** Observed contributing District owned storm sewer inlets in the River West Lot and South Access Road - no flow observed. Inlets are dry.

If suspect, illicit discharge is observed originating from SEWPBPD's owned and operated MS4, field analysis shall be conducted. Refer to the IDDE Program Manual and the WPDES Permit, Section II, C.2.e to track source. If illicit discharge originates from the ballpark sample(s) will be collected for lab analysis.

## Sampling summary if illicit discharge originates from SEWPBPD's owned and operated MS4

Time of Sampling:            Bottle Numbering:

Lab Drop Off Date/Time:

Maintain Chain of Custody on File with this Inspection Report.





# Illicit Discharge Detection and Elimination (IDDE) Inspection Form

WPDES Permit No. WI-S049921-04

Inspection form effective date: August 1, 2022

<b>Date:</b> August 18, 2022	<b>Inspector(s) Name(s):</b> Kathryn McNelly Bell & Megan Ruemler
<b>Time:</b> 2:15 PM	<b>Inspector(s) Title(s):</b> Natural Resources Staff
<b>Major Outfall Inspected (circle one):</b> MO-1 MO-2 MO-3N MO-4M	<b>Inspectors Phone Number(s):</b> 414-795-4305
MO-5S MO-6N MO-7S <b>MO-8</b>	<b>Weather:</b> 80 °F, Partly Sunny
<b>Event occurring at ballpark:</b> 1:10 PM game VS. LA Dodgers (Brewers won 5-3)	<b>Amount of last rainfall (list source):</b> 0.02" (National Weather Service; weather.gov)
<b>Date of last rainfall:</b> 8/13/22	

## Visual Observations

**Flow observed:** Yes/**No** – If Yes-continue filling out remainder of this section.

**Color:** None

**Odor:** Yes/No/**N/A**

**Turbidity:** Yes/No/**N/A**

**Oil sheen:** Yes/No/**N/A**

**Surface scum/algae:** Yes/No/**N/A**

**Flow rate (monitoring equipment can provide flow rates if flow at outfall is greater than 1.25" in depth – if less than 1.25" in depth please state this):**

**Other Relevant Observations:** Concrete outfall apron is dry.

If suspect, illicit discharge is observed originating from SEWPBPD's owned and operated MS4, field analysis shall be conducted. Refer to the IDDE Program Manual and the WPDES Permit, Section II, C.2.e to track source. If illicit discharge originates from the ballpark sample(s) will be collected for lab analysis.

## Sampling summary if illicit discharge originates from SEWPBPD's owned and operated MS4

Time of Sampling:                      Bottle Numbering:

Lab Drop Off Date/Time:

Maintain Chain of Custody on File with this Inspection Report.



**From:** [Kristi Kreklow](#)  
**To:** [Kathryn M. McNelly Bell](#)  
**Subject:** FW: Saturday bus incident  
**Date:** Tuesday, September 13, 2022 12:51:01 PM  
**Attachments:** [image002.png](#)  
[image004.png](#)  
[image009.png](#)  
[image010.png](#)  
[image011.png](#)  
[image012.png](#)

---

FYI

Kristi Kreklow | Associate Director  
Southeast Wisconsin Professional Baseball Park District  
American Family Field  
1 Brewers Way , Milwaukee, WI 53214  
E-mail: [kkreklow@wibaseballdistrict.com](mailto:kkreklow@wibaseballdistrict.com)  
P: (414) 902-4045 C: (414) 628-5933

---

**From:** Pat Goss <[pgoss@wibaseballdistrict.com](mailto:pgoss@wibaseballdistrict.com)>  
**Date:** Tuesday, September 13, 2022 at 12:20 PM  
**To:** Kristi Kreklow <[kkreklow@wibaseballdistrict.com](mailto:kkreklow@wibaseballdistrict.com)>, Steve Ethier <[Steve.ethier@brewers.com](mailto:Steve.ethier@brewers.com)>, Mike Brockman <[Mike.Brockman@brewers.com](mailto:Mike.Brockman@brewers.com)>, Matt Lehmann <[Matt.lehmann@brewers.com](mailto:Matt.lehmann@brewers.com)>  
**Subject:** FW: Saturday bus incident

FYI.

---

**From:** Passante, Elexius K - DNR <[elexius.passante@wisconsin.gov](mailto:elexius.passante@wisconsin.gov)>  
**Sent:** Thursday, September 8, 2022 3:35 PM  
**To:** Pat Goss <[pgoss@wibaseballdistrict.com](mailto:pgoss@wibaseballdistrict.com)>  
**Cc:** Katt, Samantha J - DNR <[samantha.katt@wisconsin.gov](mailto:samantha.katt@wisconsin.gov)>  
**Subject:** RE: Saturday bus incident

Hi Pat-

Thanks for the additional information, it sounds like the District implemented their response procedure and cleaned it up in a timely manner.

Just a reminder to make sure that this spill has been documented and should be turned in with the next MS4 Annual Report as stated in the IDDE section of the permit (located on page 10):

- 4. Documentation:** The permittee shall maintain a system for documenting complaints, referrals, and any actions taken to investigate or eliminate an illicit discharge. A summary of illicit discharge activities for each year shall be included in the annual report.

Thanks again!  
Lexi



**We are committed to service excellence.**

Visit our survey at <http://dnr.wi.gov/customersurvey> to evaluate how I did.

*Lexi Passante*

Stormwater Specialist

Watershed Bureau/External Services Division

Wisconsin Department of Natural Resources

**Phone:** 414-940-9860

**Email:** [elexius.passante@wisconsin.gov](mailto:elexius.passante@wisconsin.gov)



[dnr.wi.gov](http://dnr.wi.gov)



---

**From:** Pat Goss <[pgoss@wibaseballdistrict.com](mailto:pgoss@wibaseballdistrict.com)>

**Sent:** Tuesday, September 6, 2022 1:33 PM

**To:** Passante, Elexius K - DNR <[elexius.passante@wisconsin.gov](mailto:elexius.passante@wisconsin.gov)>

**Subject:** FW: Saturday bus incident

**CAUTION: This email originated from outside the organization.**

**Do not click links or open attachments unless you recognize the sender and know the content is safe.**

Here is the photo Lexi. The spill was call in to the DNR by another bus driver. The DNR employee(s) determined that it was an accident and did not issue a citation. By the time Brewers staff got out there, the DNR employee(s) were already gone. The Brewers applied some type of absorbent to the spill and then swept it up. Please let me know if you need anything else.



**MATT LEHMANN**

**Milwaukee Brewers Baseball Club**

Senior Director - Event Services

[Matt.Lehmann@brewers.com](mailto:Matt.Lehmann@brewers.com) • [414-902-4445](tel:414-902-4445)

American Family Field • One Brewers Way • Milwaukee, WI 53214

[BREWERS.COM](http://BREWERS.COM)

TICKETS

**Illicit Discharge Detection and Elimination (IDDE) Inspection Form**  
WPDES Permit No. WI-S049921-04  
Inspection form effective date: August 1, 2022

<b>Date:</b> 11/23/2022	<b>Inspector(s) Name(s):</b> Kathryn McNelly-Bell
<b>Time:</b> 1:00pm – 2:40pm	<b>Inspector(s) Title(s):</b> Proj. Mgr.
<b>Major Outfall Inspected (circle one):</b> MO-1 MO-2 MO-3N MO-4M MO-5S <b>MO-6N</b> <b>MO-7S</b> MO-8	<b>Inspectors Phone Number(s):</b> 414-795-4305
<b>Event occurring at ballpark:</b> No events at ballpark. I was completing a quarterly pond inspection, while out I noticed discharge from MO-6N and MO-7S. While on-site I verified none of the other District outfalls contained flow.	<b>Weather:</b> 57 °F, mostly sunny <b>Date of last rainfall:</b> 11/19/2022 <b>Amount of last rainfall (list source):</b> 0.02” (National Weather Service <a href="http://www.weather.gov/wrh/Climate?wfo=mkx">www.weather.gov/wrh/Climate?wfo=mkx</a> )

**Visual Observations**

**Flow observed:**  Yes / No – If Yes continue filling out remainder of this section.

**Color:** Chalky white color      **Odor:** Yes  No / NA      **Turbidity:**  Yes / No / N/A

**Oil sheen:** Yes  No / N/A      **Surface scum/algae:** Yes  No / N/A

**Flow rate (monitoring equipment can provide flow rates if flow at outfall is greater than 1.25” in depth – if less than 1.25” in depth please state this):** Less than 1.25” of flow at MO-6N and MO-7S. Upstream Wood Creek near STH 175 and Hank Aaron State Trail contained 6” + depth, but location was inaccessible (fenced off).

**Other Relevant Observations:** Observed chalky white colored flow upstream near STH 175 from the Hank Aaron State Trail. Verified flow originated from off-site, upstream (not SEWPBPD owned/operated MS4) and the catch basins in River West Parking lot and South Access Road were dry. Sampling not conducted.

Communication that took place: Multiple. Called DNR Spills Hotline and District. Discussed with Luke Reutman w/ the DNR Spills Team – I sent him (via text) photos of the discharge along with a map image of the location; and sent via text photos of Wood Creek upstream and off-site along STH 175 along w/ a map image. District notified other area MS4s via email. Additional email communications along with later inspection by DNR occurred. See attached emails documenting some of the communications by District, Kapur, other area MS4s, and DNR.

If suspect, illicit discharge is observed originating from SEWPBPD's owned and operated MS4, field analysis shall be conducted. Refer to the IDDE Program Manual and the WPDES Permit, Section II, C.2.e to track source. If illicit discharge originates from the ballpark sample(s) will be collected for lab analysis.

**Sampling summary if illicit discharge originates from SEWPBPD's owned and operated MS4**

Time of Sampling:            Bottle Numbering:

Lab Drop Off Date/Time:

Maintain Chain of Custody on File with this Inspection Report.



**From:** [Kristi Kreklow](#)  
**To:** [Kathryn M. McNelly Bell](#)  
**Subject:** FW: Illicit discharge into Menomonee River  
**Date:** Monday, December 5, 2022 9:40:43 AM  
**Attachments:** [image001.png](#)  
[image003.png](#)  
[image007.png](#)  
[image008.png](#)  
[image009.png](#)  
[image010.png](#)  
[image011.png](#)  
[image013.png](#)  
[image015.png](#)  
**Importance:** High

---

Final email related to 11/23/22 discharge.

Kristi Kreklow | Associate Director  
Southeast Wisconsin Professional Baseball Park District  
American Family Field  
1 Brewers Way, Milwaukee, WI 53214  
E-mail: [kkreklow@wibaseballdistrict.com](mailto:kkreklow@wibaseballdistrict.com)  
P: (414) 902-4045 C: (414) 628-5933

---

**From:** "Passante, Elexius K - DNR" <[elexius.passante@wisconsin.gov](mailto:elexius.passante@wisconsin.gov)>  
**Date:** Monday, December 5, 2022 at 8:31 AM  
**To:** Pat Goss <[pgoss@wibaseballdistrict.com](mailto:pgoss@wibaseballdistrict.com)>, "Katt, Samantha J - DNR" <[samantha.katt@wisconsin.gov](mailto:samantha.katt@wisconsin.gov)>, "Benninghoff, Benjamin D - DNR" <[Benjamin.Benninghoff@wisconsin.gov](mailto:Benjamin.Benninghoff@wisconsin.gov)>  
**Cc:** Kristi Kreklow <[kkreklow@wibaseballdistrict.com](mailto:kkreklow@wibaseballdistrict.com)>  
**Subject:** RE: Illicit discharge into Menomonee River

Hi Pat-

Thank you for your email and hope you had a good weekend. Just a reminder, though the spill did not originate from the District, please make sure documentation of the event it is submitted with the District's next MS4 Annual Report!

As for your email address being dropped in the email correspondence, I am unsure why that occurred. It looks like it was an transcription error once the DNR spills folks got involved. In the future, I can make sure you are consistently cc'd on email chains!

Thanks,  
Lexi

**We are committed to service excellence.**

Visit our survey at <http://dnr.wi.gov/customersurvey> to evaluate how I did.

*Lexi Passante*

Stormwater Specialist  
Watershed Bureau/External Services Division  
Wisconsin Department of Natural Resources  
**Phone:** 414-940-9860

**Email:** [elexius.passante@wisconsin.gov](mailto:elexius.passante@wisconsin.gov)



[dnr.wi.gov](http://dnr.wi.gov)



---

**From:** Pat Goss <[pgoss@wibaseballdistrict.com](mailto:pgoss@wibaseballdistrict.com)>  
**Sent:** Friday, December 2, 2022 1:21 PM  
**To:** Passante, Elexius K - DNR <[elexius.passante@wisconsin.gov](mailto:elexius.passante@wisconsin.gov)>; Katt, Samantha J - DNR <[samantha.katt@wisconsin.gov](mailto:samantha.katt@wisconsin.gov)>; Benninghoff, Benjamin D - DNR <[Benjamin.Benninghoff@wisconsin.gov](mailto:Benjamin.Benninghoff@wisconsin.gov)>  
**Cc:** Kristi Kreklow <[kkreklow@wibaseballdistrict.com](mailto:kkreklow@wibaseballdistrict.com)>  
**Subject:** Illicit discharge into Menomonee River  
**Importance:** High

**CAUTION: This email originated from outside the organization.  
Do not click links or open attachments unless you recognize the sender and know the content is safe.**

Sam, Lexi and Ben:

Based on the 11-25 email from Jane Pfeiffer with DNR, we are considering this issue closed. Please let us know if you have any further developments from other sites on this issue.

Also, I was on the emails initially from the locals. However, once DNR got involved, I was dropped. Can one of you please address that internally or let me know who I need to contact? Thank you.

Pat

---

**From:** "Pfeiffer, Jane K - DNR" <[jane.pfeiffer@wisconsin.gov](mailto:jane.pfeiffer@wisconsin.gov)>  
**Date:** Friday, November 25, 2022 at 12:38 PM  
**To:** "Reuteman, Luke T - DNR" <[luke.reuteman@wisconsin.gov](mailto:luke.reuteman@wisconsin.gov)>, "Passante, Elexius K - DNR" <[elexius.passante@wisconsin.gov](mailto:elexius.passante@wisconsin.gov)>, "Sprangers, Kurt" <[kspran@milwaukee.gov](mailto:kspran@milwaukee.gov)>, "[james.stenzel@westmilwaukee.org](mailto:james.stenzel@westmilwaukee.org)" <[james.stenzel@westmilwaukee.org](mailto:james.stenzel@westmilwaukee.org)>, "Hallanger, Hans D - DOT" <[hans.hallanger@dot.wi.gov](mailto:hans.hallanger@dot.wi.gov)>, "Kathryn M. McNelly Bell" <[kmcnelly@kapurinc.com](mailto:kmcnelly@kapurinc.com)>  
**Cc:** "[James.Beier@va.gov](mailto:James.Beier@va.gov)" <[James.Beier@va.gov](mailto:James.Beier@va.gov)>, "Neumann, Riley D - DNR" <[Riley.Neumann@wisconsin.gov](mailto:Riley.Neumann@wisconsin.gov)>, "Katt, Samantha J - DNR" <[samantha.katt@wisconsin.gov](mailto:samantha.katt@wisconsin.gov)>, "Schrank, Jayson S - DNR" <[jayson.schrank@wisconsin.gov](mailto:jayson.schrank@wisconsin.gov)>, "Haferkorn, Samuel J - DNR" <[Samuel.Haferkorn@wisconsin.gov](mailto:Samuel.Haferkorn@wisconsin.gov)>, "Anderson, Erik R - DNR" <[erik.anderson@wisconsin.gov](mailto:erik.anderson@wisconsin.gov)>, "Yang, Meng - DNR" <[meng.yang@wisconsin.gov](mailto:meng.yang@wisconsin.gov)>,

"Lambert, Jamie D - DNR" <[Jamie.Lambert@wisconsin.gov](mailto:Jamie.Lambert@wisconsin.gov)>, Kristi Kreklow <[kkreklow@wibaseballdistrict.com](mailto:kkreklow@wibaseballdistrict.com)>

**Subject:** RE: Illicit discharge into Menomonee River

Hi All – DNR Warden Meng Yang performed a site visit today at locations 1-3 (see discharge map attached) at approximately 11AM and took the attached photos. Meng did not observe the chalky substance/any impacts in the Menomonee River at locations 2 and 3 (both of which are upstream of location 1). Meng indicated that location 1 appeared to have a faint residual chalky tint, but was not sure that it was the same chalky color and/or an discoloration due to the sun's glare on the water. Meng indicated that there were several fish swimming around at location 1 and no fish/wildlife impacts were observed.

This is the only additional information I have to share at this time. Unless I receive new information today, this will likely be my last update on this unknown discharge.

Thanks, Jane

**We are committed to service excellence.**

Visit our survey at <http://dnr.wi.gov/customersurvey> to evaluate how I did.

Jane Pfeiffer

Phone: (414) 435-8021

[jane.pfeiffer@wisconsin.gov](mailto:jane.pfeiffer@wisconsin.gov)

---

**From:** Reuteman, Luke T - DNR <[luke.reuteman@wisconsin.gov](mailto:luke.reuteman@wisconsin.gov)>

**Sent:** Wednesday, November 23, 2022 5:03 PM

**To:** Passante, Elexius K - DNR <[elexius.passante@wisconsin.gov](mailto:elexius.passante@wisconsin.gov)>; Sprangers, Kurt <[kspran@milwaukee.gov](mailto:kspran@milwaukee.gov)>; [james.stenzel@westmilwaukee.org](mailto:james.stenzel@westmilwaukee.org); Hallanger, Hans D - DOT <[hans.hallanger@dot.wi.gov](mailto:hans.hallanger@dot.wi.gov)>; Kathryn M. McNelly Bell <[kmcnelly@kapurinc.com](mailto:kmcnelly@kapurinc.com)>

**Cc:** [James.Beier@va.gov](mailto:James.Beier@va.gov); Neumann, Riley D - DNR <[Riley.Neumann@wisconsin.gov](mailto:Riley.Neumann@wisconsin.gov)>; Pfeiffer, Jane K - DNR <[jane.pfeiffer@wisconsin.gov](mailto:jane.pfeiffer@wisconsin.gov)>; Katt, Samantha J - DNR <[samantha.katt@wisconsin.gov](mailto:samantha.katt@wisconsin.gov)>; Schrank, Jayson S - DNR <[jayson.schrank@wisconsin.gov](mailto:jayson.schrank@wisconsin.gov)>; Haferkorn, Samuel J - DNR <[Samuel.Haferkorn@wisconsin.gov](mailto:Samuel.Haferkorn@wisconsin.gov)>; Anderson, Erik R - DNR <[erik.anderson@wisconsin.gov](mailto:erik.anderson@wisconsin.gov)>; Yang, Meng - DNR <[meng.yang@wisconsin.gov](mailto:meng.yang@wisconsin.gov)>; Lambert, Jamie D - DNR <[Jamie.Lambert@wisconsin.gov](mailto:Jamie.Lambert@wisconsin.gov)>; Kristi Kreklow <[kkreklow@wibaseballdistrict.com](mailto:kkreklow@wibaseballdistrict.com)>

**Subject:** RE: Illicit discharge into Menomonee River

Hello all,

I followed up on this spill with Kathryn McNelly Bell of Kapur and understand the following details:

1. On the attached google earth snapshot, location 1. Is where the discharge was first observed. Photos 1a and 1b are associated with this location.
2. The substance was observed at this location as well, as shown in Photo 2.

3. The substance was not observed at this location, shown in Photo 3. This location is upgradient of the prior two locations.

No impacts to fish or wildlife were observed. I reached out to two Komatsu contacts and left messages with each, and at this time the source is unknown and the investigation is ongoing. The DNR Spills on-call contact tomorrow will be Jayson Schrank (715-410-8841), and Jane Pfeiffer (414-435-8021) will be the southeast DNR Spills contact on Friday. Please keep us in the loop regarding this spill, and if anyone has any additional information please do not hesitate to reach out.

See the SERTS notification below for additional spill information.

Thank you,  
Luke

**Luke T. Reuteman**

Hydrogeologist  
Remediation and Redevelopment Program  
Wisconsin Department of Natural Resources  
1027 W St. Paul Avenue  
Milwaukee, WI 53233  
Phone: 414-659-7204  
[luke.reuteman@wisconsin.gov](mailto:luke.reuteman@wisconsin.gov)



---

**From:** Kathryn M. McNelly Bell <[kmcnelly@kapurinc.com](mailto:kmcnelly@kapurinc.com)>  
**Sent:** Wednesday, November 23, 2022 4:29 PM  
**To:** Passante, Elexius K - DNR <[elexius.passante@wisconsin.gov](mailto:elexius.passante@wisconsin.gov)>; Kristi Kreklow <[kkreklow@wibaseballdistrict.com](mailto:kkreklow@wibaseballdistrict.com)>; Sprangers, Kurt <[kspran@milwaukee.gov](mailto:kspran@milwaukee.gov)>; [james.stenzel@westmilwaukee.org](mailto:james.stenzel@westmilwaukee.org); Hallanger, Hans D - DOT <[hans.hallanger@dot.wi.gov](mailto:hans.hallanger@dot.wi.gov)>; Reuteman, Luke T - DNR <[luke.reuteman@wisconsin.gov](mailto:luke.reuteman@wisconsin.gov)>  
**Cc:** Pat Goss <[pgoss@wibaseballdistrict.com](mailto:pgoss@wibaseballdistrict.com)>; [James.Beier@va.gov](mailto:James.Beier@va.gov); Mike Brockman <[Mike.Brockman@brewers.com](mailto:Mike.Brockman@brewers.com)>; Neumann, Riley D - DNR <[Riley.Neumann@wisconsin.gov](mailto:Riley.Neumann@wisconsin.gov)>; Pfeiffer, Jane K - DNR <[jane.pfeiffer@wisconsin.gov](mailto:jane.pfeiffer@wisconsin.gov)>; Katt, Samantha J - DNR <[samantha.katt@wisconsin.gov](mailto:samantha.katt@wisconsin.gov)>  
**Subject:** RE: Illicit discharge into Menomonee River

**CAUTION: This email originated from outside the organization.  
Do not click links or open attachments unless you recognize the sender and know the content is safe.**



Hi Lexi-

I've been in contact w/ Luke Reuteman w/ DNR (Spills) and have provided him w/ documentation. He is now included on this email chain. He indicated that he will be following up on this. Due to file size limitations, please contact Luke and he can share internally. This will be documented as standard practice w/ our next MS4 Biennial Report submittal. If you need anything in the meantime, please let Kristi or I know. With the Holiday it would be best to call.

Kind Regards,

**Kathryn M. McNelly Bell**

Associate / Natural Resources Department Manager/ CPESC PWS

1224 S Pine Street, Burlington, Wisconsin 53105

m: 414.795.4305 o: 414.751.7282 kapur.com

An Equal Opportunity / Affirmative Action Employer

#1 Company in the Extra-Large Category. Read more [here](#).

---

**From:** Passante, Elexius K - DNR <[elexius.passante@wisconsin.gov](mailto:elexius.passante@wisconsin.gov)>

**Sent:** Wednesday, November 23, 2022 3:56 PM

**To:** Kristi Kreklow <[kkreklow@wibaseballdistrict.com](mailto:kkreklow@wibaseballdistrict.com)>; Sprangers, Kurt <[kspran@milwaukee.gov](mailto:kspran@milwaukee.gov)>; [james.stenzel@westmilwaukee.org](mailto:james.stenzel@westmilwaukee.org); Hallanger, Hans D - DOT <[hans.hallanger@dot.wi.gov](mailto:hans.hallanger@dot.wi.gov)>

**Cc:** Pat Goss <[pgoss@wibaseballdistrict.com](mailto:pgoss@wibaseballdistrict.com)>; Kathryn M. McNelly Bell <[kmcnelly@kapurinc.com](mailto:kmcnelly@kapurinc.com)>; [James.Beier@va.gov](mailto:James.Beier@va.gov); Mike Brockman <[Mike.Brockman@brewers.com](mailto:Mike.Brockman@brewers.com)>; Neumann, Riley D - DNR <[Riley.Neumann@wisconsin.gov](mailto:Riley.Neumann@wisconsin.gov)>; Pfeiffer, Jane K - DNR <[jane.pfeiffer@wisconsin.gov](mailto:jane.pfeiffer@wisconsin.gov)>; Katt, Samantha J - DNR <[samantha.katt@wisconsin.gov](mailto:samantha.katt@wisconsin.gov)>

**Subject:** RE: Illicit discharge into Menomonee River

You don't often get email from [elexius.passante@wisconsin.gov](mailto:elexius.passante@wisconsin.gov). [Learn why this is important](#)

Hi everyone-

Thank you Kristi for calling this ongoing discharge into the WDNR spills hotline— demonstrating implementation of the District's IDDE program response procedures. Although the spill has not originated from the District, please make sure the spill has been documented and turned in with the next MS4 Annual Report.

I have cc'd our WDNR contacts, Jane and Riley so they are informed with this ongoing discharge.

Please keep us in the loop on this investigation, and if you need any assistance. I did look into what permitted construction sites are within the reported area and couldn't find anything worth noting. However, I did search what industrial permittees are within the surrounding area (see attached, highlighted area is where reported discharge is occurring). There are two industries that could be worth looking into: National Salvage LTD (circled and shown as the plus-shaped symbol on the map)

and Komatsu Mining Corp (circled and shown as the diamond shape symbol).

Thank you!

Lexi

**We are committed to service excellence.**

Visit our survey at <http://dnr.wi.gov/customersurvey> to evaluate how I did.

*Lexi Passante*

Stormwater Specialist

Watershed Bureau/External Services Division

Wisconsin Department of Natural Resources

**Phone:** 414-940-9860

**Email:** [elexus.passante@wisconsin.gov](mailto:elexus.passante@wisconsin.gov)



[dnr.wi.gov](http://dnr.wi.gov)



---

**From:** Kristi Kreklow <[kkreklow@wibaseballdistrict.com](mailto:kkreklow@wibaseballdistrict.com)>

**Sent:** Wednesday, November 23, 2022 2:54 PM

**To:** Sprangers, Kurt <[kspran@milwaukee.gov](mailto:kspran@milwaukee.gov)>; [james.stenzel@westmilwaukee.org](mailto:james.stenzel@westmilwaukee.org); Hallanger, Hans D - DOT <[hans.hallanger@dot.wi.gov](mailto:hans.hallanger@dot.wi.gov)>

**Cc:** Passante, Elexius K - DNR <[elexus.passante@wisconsin.gov](mailto:elexus.passante@wisconsin.gov)>; Pat Goss <[pgoss@wibaseballdistrict.com](mailto:pgoss@wibaseballdistrict.com)>; Kathryn M. McNelly Bell <[kmcnelly@kapurinc.com](mailto:kmcnelly@kapurinc.com)>; [James.Beier@va.gov](mailto:James.Beier@va.gov); Mike Brockman <[Mike.Brockman@brewers.com](mailto:Mike.Brockman@brewers.com)>

**Subject:** Re: Illicit discharge into Menomonee River

**CAUTION: This email originated from outside the organization.**

**Do not click links or open attachments unless you recognize the sender and know the content is safe.**

A copy of the DNR report is below. I just confirmed that there is still flow coming from the two outfalls.

**From:** [dnrlehotline@wisconsin.gov](mailto:dnrlehotline@wisconsin.gov)<[dnrlehotline@wisconsin.gov](mailto:dnrlehotline@wisconsin.gov)>

**Sent:** Wednesday, November 23, 2022 1:54:44 PM

**To:** Kathryn M. McNelly Bell <[kmcnelly@kapurinc.com](mailto:kmcnelly@kapurinc.com)>

**Subject:** WI SPILL #18487 ID 20221123SE41-1 - UNKNOWN

[You don't often get email from [dnrlehotline@wisconsin.gov](mailto:dnrlehotline@wisconsin.gov). Learn why this is important at <https://aka.ms/LearnAboutSenderIdentification> ]

SERTS ID:

20221123SE41-1

Reported:

11/23/2022 13:33

Occurred:

UNKNOWN

Substance:

UNKNOWN

WHITE CHALKY SUBSTANCE

AMOUNT RELEASED AND  
AMOUNT RECOVERED ARE  
UNKNOWN AT THIS TIME

Reported by:

KATHRYN

NATURAL RESOURCE DEPARTMENT MANAGER

KAPUR

(414) 795-4305

Location:

SE REGION

MILWAUKEE COUNTY

MILWAUKEE, CITY OF

FIELD ADDRESS

1 BREWERS WAY

Responsible Party:

UNKNOWN

Cause:

UNKNOWN

Cause Description:

INSPECTION OF THE AMERICAN FAMILY BASEBALL FIELD, NOTICED DISCHARGE FROM THE WOODCREEK OUTFALL DISCHARGING INTO THE MENOMONEE RIVER. MAJOR OUTFALL 7 SOUTH AND MAJOR OUTFALL 6 NORTH. A WHITE CHALKY SUBSTANCE WITH NO OBVIOUS ODOR.

Environmental Impact:

EMPTYING IN TO THE MENOMINEE RIVER

Comments:

RP IS TRAVELING OVER TOWARDS THE KOMATSU PLANT NEAR THE HANK AARONS TRAIL TO CHECK

IF SHE CAN FIND THE SOURCE.

Cleanup:

CLEAN-UP PROGRESS UNKNOWN OR CLEAN-UP NOT STARTED.

Notified SPOKE TO LUKE REUTEMAN at 13:45 by

Submitted by:

JACOB MCKAY

(888) 936-7463

[dnrlehotline@wisconsin.gov](mailto:dnrlehotline@wisconsin.gov)

Get [Outlook for iOS](#)

---

**From:** Sprangers, Kurt <[kspran@milwaukee.gov](mailto:kspran@milwaukee.gov)>  
**Sent:** Wednesday, November 23, 2022 2:24 PM  
**To:** Kristi Kreklow <[kkreklow@wibaseballdistrict.com](mailto:kkreklow@wibaseballdistrict.com)>; [james.stenzel@westmilwaukee.org](mailto:james.stenzel@westmilwaukee.org) <[james.stenzel@westmilwaukee.org](mailto:james.stenzel@westmilwaukee.org)>; [Hans.hallanger@dot.wi.gov](mailto:Hans.hallanger@dot.wi.gov) <[Hans.hallanger@dot.wi.gov](mailto:Hans.hallanger@dot.wi.gov)>  
**Cc:** [elexius.passante@wisconsin.gov](mailto:elexius.passante@wisconsin.gov) <[elexius.passante@wisconsin.gov](mailto:elexius.passante@wisconsin.gov)>; Pat Goss <[pgoss@wibaseballdistrict.com](mailto:pgoss@wibaseballdistrict.com)>; Kathryn M. McNelly Bell <[kmcnelly@kapurinc.com](mailto:kmcnelly@kapurinc.com)>; [James.Beier@va.gov](mailto:James.Beier@va.gov) <[James.Beier@va.gov](mailto:James.Beier@va.gov)>; Mike Brockman <[Mike.Brockman@brewers.com](mailto:Mike.Brockman@brewers.com)>  
**Subject:** Re: Illicit discharge into Menomonee River

I'm also adding James Beier of the VA Grounds. This appears to be the outfall that Woods Creek is tributary to and I do believe they are doing construction work on or around the creek. It does not appear the City of Milwaukee has storm sewers tributary to this outfall.

-

**Kurt Sprangers, P.E. CFM** | Engineer in Charge | City of Milwaukee - Environmental Engineering  
841 N Broadway - Rm 820 | Milwaukee, WI 53202 | p: 414.286.0515 | [kspran@milwaukee.gov](mailto:kspran@milwaukee.gov)

---

**From:** Kristi Kreklow <[kkreklow@wibaseballdistrict.com](mailto:kkreklow@wibaseballdistrict.com)>  
**Sent:** Wednesday, November 23, 2022 2:05 PM  
**To:** [james.stenzel@westmilwaukee.org](mailto:james.stenzel@westmilwaukee.org) <[james.stenzel@westmilwaukee.org](mailto:james.stenzel@westmilwaukee.org)>; Sprangers, Kurt <[kspran@milwaukee.gov](mailto:kspran@milwaukee.gov)>; [njaber@milwaukee.gov](mailto:njaber@milwaukee.gov) <[njaber@milwaukee.gov](mailto:njaber@milwaukee.gov)>; [Hans.hallanger@dot.wi.gov](mailto:Hans.hallanger@dot.wi.gov) <[Hans.hallanger@dot.wi.gov](mailto:Hans.hallanger@dot.wi.gov)>  
**Cc:** [elexius.passante@wisconsin.gov](mailto:elexius.passante@wisconsin.gov) <[elexius.passante@wisconsin.gov](mailto:elexius.passante@wisconsin.gov)>; Pat Goss <[pgoss@wibaseballdistrict.com](mailto:pgoss@wibaseballdistrict.com)>; Kathryn M. McNelly Bell <[kmcnelly@kapurinc.com](mailto:kmcnelly@kapurinc.com)>; Mike Brockman <[Mike.Brockman@brewers.com](mailto:Mike.Brockman@brewers.com)>  
**Subject:** Illicit discharge into Menomonee River

Dear City of Milwaukee, Village of West Milwaukee, and Wisconsin Department of Transportation:

The District is writing to inform you that it has detected an illicit discharge into the Menomonee River from Major Outfall 6 North (MO-6N) and Major Outfall 7 South (MO-7S) today at approximately 1:00 pm (see the attached map and pin drop for reference). Please let me know if you are not the correct point of contact for this notice.

Additional investigation has determined that this discharge does not originate from the District's property. The DNR spills hotline has been notified.

<b>Adjacent MS4</b>	<b>Contact</b>	<b>Phone</b>	<b>Email</b>
City of Milwaukee	1) Kurt Sprangers 2) Nader Jaber	(414) 286-0515 (414) 286-0514	<a href="mailto:kspran@milwaukee.gov">kspran@milwaukee.gov</a> <a href="mailto:njaber@milwaukee.gov">njaber@milwaukee.gov</a>
Village of West Milwaukee	James Stenzel <i>After Hours</i>	(414) 645-6238 (414) 645-2151	<a href="mailto:james.stenzel@westmilwaukee.org">james.stenzel@westmilwaukee.org</a>
WI DOT	Hans Hallanger	(608) 266-0279	<a href="mailto:Hans.hallanger@dot.wi.gov">Hans.hallanger@dot.wi.gov</a>

Don't hesitate to contact me with any questions or concerns.

Regards,  
Kristi

Kristi Kreklow | Associate Director  
Southeast Wisconsin Professional Baseball Park District  
American Family Field  
1 Brewers Way , Milwaukee, WI 53214  
E-mail: [kkreklow@wibaseballdistrict.com](mailto:kkreklow@wibaseballdistrict.com)  
P: (414) 902-4045 C: (414) 628-5933

The City of Milwaukee is subject to Wisconsin Statutes related to public records. Unless otherwise exempted from the public records law, senders and receivers of City of Milwaukee e-mail should presume that e-mail is subject to release upon request, and is subject to state records retention requirements. See City of Milwaukee full e-mail disclaimer at [www.milwaukee.gov/email\\_disclaimer](http://www.milwaukee.gov/email_disclaimer)

**From:** Kathryn M. McNelly Bell  
**To:** Kristi Kreklow; luke.reuteman@wisconsin.gov  
**Subject:** RE: Illicit discharge into Menomonee River  
**Date:** Wednesday, November 23, 2022 4:19:00 PM  
**Attachments:** DOT-Drainage Area Near-Miller Park.pdf  
 ma0e001.png

Hi Luke –

The Southeast Wisconsin Professional Baseball Park District (SEWPBPD) (contact Kristi Kreklow) is coordinating w/ other area MS4s. I will send separate emails w/ photos (due to size limits) along w/ the texts I sent to you w/ photos and Google Map locations as requested – I hope this will be helpful to you w/ your follow-up. Also DOT provided a drainage area map in correspondence w/ Kristi (see attached .pdf DOT Drainage Area...pdf) and the image below is from the SEWPBPD's Storm Sewer System Map which shows the 5 Wood Creek outfalls to the Menomonee River – flow was observed from MO-6N and MO-7s (see yellow arrow).

The SEWPBPD's WPDES Permit Number is WI-S049921-04 and our permitting contact is Samantha Katt. We have other materials on file w/ the DNR (permitting dashboard) like the IDDE Program Manual. For your use – I also attached the SEWPBPD's Storm Sewer System Map in its entirety.

I will be logging out for the Holiday, but will have my phone available during business hours (8-5) over the next 2 days 414-795-4305. Thank you! Kathryn

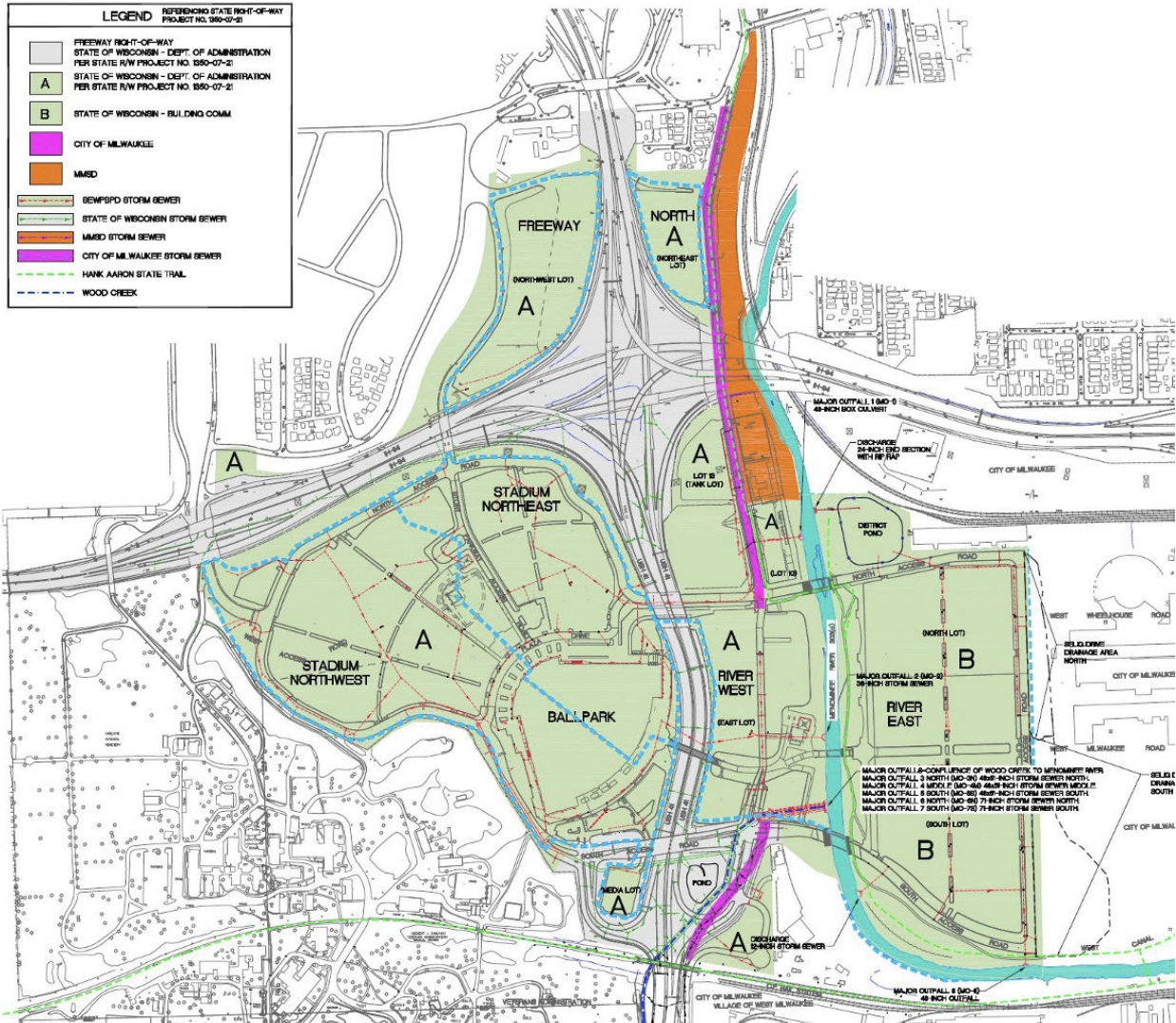

 Kathryn M. McNelly Bell  
 Associate / Natural Resources Department Manager/ CPESC PWS  
 1224 S Pine Street, Burlington, Wisconsin 53105  
 m: 414.795.4305 o: 414.751.7282 kapur.com  
 An Equal Opportunity / Affirmative Action Employer  
[BP2W-2022](#)  
  
 #1 Company in the Extra-Large Category. Read more [here](#).

**Kathryn M. McNelly Bell**  
 M: 414.795.4305  
 O: 414.751.7282

**From:** Kristi Kreklow <kkreklow@wibasealldistrict.com>  
**Sent:** Wednesday, November 23, 2022 2:54 PM  
**To:** Sprangers, Kurt <kspran@milwaukee.gov>; james.stenzel@westmilwaukee.org; Hans.hallanger@dot.wi.gov  
**Cc:** elexius.passante@wisconsin.gov; Pat Goss <pgoss@wibasealldistrict.com>; Kathryn M. McNelly Bell <kmcnelly@kapurinc.com>; James.Beier@va.gov; Mike Brockman <Mike.Brockman@brewers.com>  
**Subject:** Re: Illicit discharge into Menomonee River

A copy of the DNR report is below. I just confirmed that there is still flow coming from the two outfalls.

**From:** [dnrlehotline@wisconsin.gov](mailto:dnrlehotline@wisconsin.gov)<[dnrlehotline@wisconsin.gov](mailto:dnrlehotline@wisconsin.gov)>  
**Sent:** Wednesday, November 23, 2022 1:54:44 PM  
**To:** Kathryn M. McNelly Bell <[kmcnelly@kapurinc.com](mailto:kmcnelly@kapurinc.com)>  
**Subject:** WI SPILL #18487 ID 20221123SE41-1 - UNKNOWN

[You don't often get email from [dnrlehotline@wisconsin.gov](mailto:dnrlehotline@wisconsin.gov). Learn why this is important at <https://aka.ms/LearnAboutSenderIdentification> ]

SERTS ID:  
20221123SE41-1

Reported:  
11/23/2022 13:33

Occurred:  
UNKNOWN

Substance:  
UNKNOWN  
WHITE CHALKY SUBSTANCE

AMOUNT RELEASED AND  
AMOUNT RECOVERED ARE  
UNKNOWN AT THIS TIME

Reported by:  
KATHRYN  
NATURAL RESOURCE DEPARTMENT MANAGER  
KAPUR  
(414) 795-4305

Location:  
SE REGION  
MILWAUKEE COUNTY  
MILWAUKEE, CITY OF  
FIELD ADDRESS  
1 BREWERS WAY

Responsible Party:  
UNKNOWN

Cause:  
UNKNOWN

Cause Description:  
INSPECTION OF THE AMERICAN FAMILY BASEBALL FIELD, NOTICED DISCHARGE FROM THE WOODCREEK OUTFALL DISCHARGING INTO THE MENOMONEE RIVER. MAJOR OUTFALL 7 SOUTH AND MAJOR OUTFALL 6 NORTH. A WHITE CHALKY SUBSTANCE WITH NO OBVIOUS ODOR.

Environmental Impact:  
EMPTYING IN TO THE MENOMINEE RIVER

Comments:  
RP IS TRAVELING OVER TOWARDS THE KOMATSU PLANT NEAR THE HANK AARONS TRAIL TO CHECK IF SHE CAN FIND THE SOURCE.

Cleanup:  
CLEAN-UP PROGRESS UNKNOWN OR CLEAN-UP NOT STARTED.

Notified SPOKE TO LUKE REUTEMAN at 13:45 by

Submitted by:  
JACOB MCKAY  
(888) 936-7463  
[dnrlehotline@wisconsin.gov](mailto:dnrlehotline@wisconsin.gov)

Get [Outlook for iOS](#)

---

**From:** Sprangers, Kurt <[kspran@milwaukee.gov](mailto:kspran@milwaukee.gov)>  
**Sent:** Wednesday, November 23, 2022 2:24 PM  
**To:** Kristi Kreklow <[kkreklow@wibasealldistrict.com](mailto:kkreklow@wibasealldistrict.com)>; james.stenzel@westmilwaukee.org <[james.stenzel@westmilwaukee.org](mailto:james.stenzel@westmilwaukee.org)>; Hans.hallanger@dot.wi.gov <[Hans.hallanger@dot.wi.gov](mailto:Hans.hallanger@dot.wi.gov)>  
**Cc:** [elexius.passante@wisconsin.gov](mailto:elexius.passante@wisconsin.gov) <[elexius.passante@wisconsin.gov](mailto:elexius.passante@wisconsin.gov)>; Pat Goss <[pgoss@wibasealldistrict.com](mailto:pgoss@wibasealldistrict.com)>; Kathryn M. McNelly Bell <[kmcnelly@kapurinc.com](mailto:kmcnelly@kapurinc.com)>; [James.Beier@va.gov](mailto:James.Beier@va.gov) <[James.Beier@va.gov](mailto:James.Beier@va.gov)>; Mike Brockman <[Mike.Brockman@brewers.com](mailto:Mike.Brockman@brewers.com)>  
**Subject:** Re: Illicit discharge into Menomonee River

I'm also adding James Beier of the VA Grounds. This appears to be the outfall that Woods Creek is tributary to and I do believe they are doing construction work on or around the creek. It does not appear the City of Milwaukee has storm sewers tributary to this outfall.

Kurt Sprangers, P.E. CFM | Engineer in Charge | City of Milwaukee - Environmental Engineering  
841 N Broadway - Rm 820 | Milwaukee, WI 53202 | p: 414.286.0515 | [kspran@milwaukee.gov](mailto:kspran@milwaukee.gov)

**From:** Kristi Kreklow <[kkreklow@wibaseballdistrict.com](mailto:kkreklow@wibaseballdistrict.com)>  
**Sent:** Wednesday, November 23, 2022 2:05 PM  
**To:** [james.stenzel@westmilwaukee.org](mailto:james.stenzel@westmilwaukee.org) <[james.stenzel@westmilwaukee.org](mailto:james.stenzel@westmilwaukee.org)>; Sprangers, Kurt <[kspran@milwaukee.gov](mailto:kspran@milwaukee.gov)>; [njaber@milwaukee.gov](mailto:njaber@milwaukee.gov) <[njaber@milwaukee.gov](mailto:njaber@milwaukee.gov)>; [Hans.hallanger@dot.wi.gov](mailto:Hans.hallanger@dot.wi.gov) <[Hans.hallanger@dot.wi.gov](mailto:Hans.hallanger@dot.wi.gov)>  
**Cc:** [elelixus.passante@wisconsin.gov](mailto:elelixus.passante@wisconsin.gov) <[elelixus.passante@wisconsin.gov](mailto:elelixus.passante@wisconsin.gov)>; Pat Goss <[pgoss@wibaseballdistrict.com](mailto:pgoss@wibaseballdistrict.com)>; Kathryn M. McNelly Bell <[kmcnelly@kapurinc.com](mailto:kmcnelly@kapurinc.com)>; Mike Brockman <[Mike.Brockman@brewers.com](mailto:Mike.Brockman@brewers.com)>  
**Subject:** Illicit discharge into Menomonee River

Dear City of Milwaukee, Village of West Milwaukee, and Wisconsin Department of Transportation:

The District is writing to inform you that it has detected an illicit discharge into the Menomonee River from Major Outfall 6 North (MO-6N) and Major Outfall 7 South (MO-7S) today at approximately 1:00 pm (see the attached map and pin drop for reference). Please let me know if you are not the correct point of contact for this notice.

Additional investigation has determined that this discharge does not originate from the District's property. The DNR spills hotline has been notified.

Adjacent MS4	Contact	Phone	Email
City of Milwaukee	1) Kurt Sprangers 2) Nader Jaber	(414) 286-0515 (414) 286-0514	<a href="mailto:kspran@milwaukee.gov">kspran@milwaukee.gov</a> <a href="mailto:njaber@milwaukee.gov">njaber@milwaukee.gov</a>
Village of West Milwaukee	James Stenzel <i>After Hours</i>	(414) 645-6238 (414) 645-2151	<a href="mailto:james.stenzel@westmilwaukee.org">james.stenzel@westmilwaukee.org</a>
WI DOT	Hans Hallanger	(608) 266-0279	<a href="mailto:Hans.hallanger@dot.wi.gov">Hans.hallanger@dot.wi.gov</a>

Don't hesitate to contact me with any questions or concerns.

Regards,  
Kristi

Kristi Kreklow | Associate Director  
Southeast Wisconsin Professional Baseball Park District  
American Family Field  
1 Brewers Way , Milwaukee, WI 53214  
E-mail: [kkreklow@wibaseballdistrict.com](mailto:kkreklow@wibaseballdistrict.com)  
P: (414) 902-4045 C: (414) 628-5933

The City of Milwaukee is subject to Wisconsin Statutes related to public records. Unless otherwise exempted from the public records law, senders and receivers of City of Milwaukee e-mail should presume that e-mail is subject to release upon request, and is subject to state records retention requirements. See City of Milwaukee full e-mail disclaimer at [www.milwaukee.gov/email\\_disclaimer](http://www.milwaukee.gov/email_disclaimer)